

P E R M I T

CITY OF NAPOLEON  
255 W. RIVERVIEW AVE  
NAPOLEON, OHIO 43545

DIVISION OF BUILDING & ZONING  
PH (419) 592-4010  
FAX (419) 599-8393

PERMIT NO: 1322

DATE ISSUED: 09-11-02

ISSUED BY: MRD

JOB LOCATION: 129 E BARNES AVE

EST. COST: 1719.50

LOT #:

SUBDIVISION NAME:

OWNER: PATRICK, DOYLE D.  
ADDRESS: 129 E. BARNES AVE  
CSZ: NAPOLEON, OH 43545  
PHONE: 419-592-6428

AGENT: B&W FENCE CO  
ADDRESS: 6209 CO RD 6-3  
CSZ: DELTA, OH 43515  
PHONE: 419-822-3436

USE TYPE - RESIDENTIAL:

OTHER:

ZONING INFORMATION

DIST: LOT DIM: AREA: FYRD: SYRD: RYRD:  
MAX HT: # PKG SPACES: # LOADING SP: MAX LOT COV:

BOARD OF ZONING APPEALS:

WORK TYPE - NEW: REPLMNT: ADD'N: ALTER: REMODEL:

WORK INFORMATION

SIZE - LGTH: WIDTH: STORIES: LIVING AREA SF:  
GARAGE AREA SF: HEIGHT: BLDG VOL DEMO PERMIT:

WORK DESCRIPTION  
NEW FENCE

FEE DESCRIPTION	PAID DATE	FEE AMOUNT DUE
BUILDING PERMIT		27.00

TOTAL FEES DUE 27.00

9-11-02

DATE

Mary J Patrick

APPLICANT SIGNATURE



6 FOOT HIGH  
CHAIN LINK FENCE  
(2) 3 FOOT WIDE  
GATES

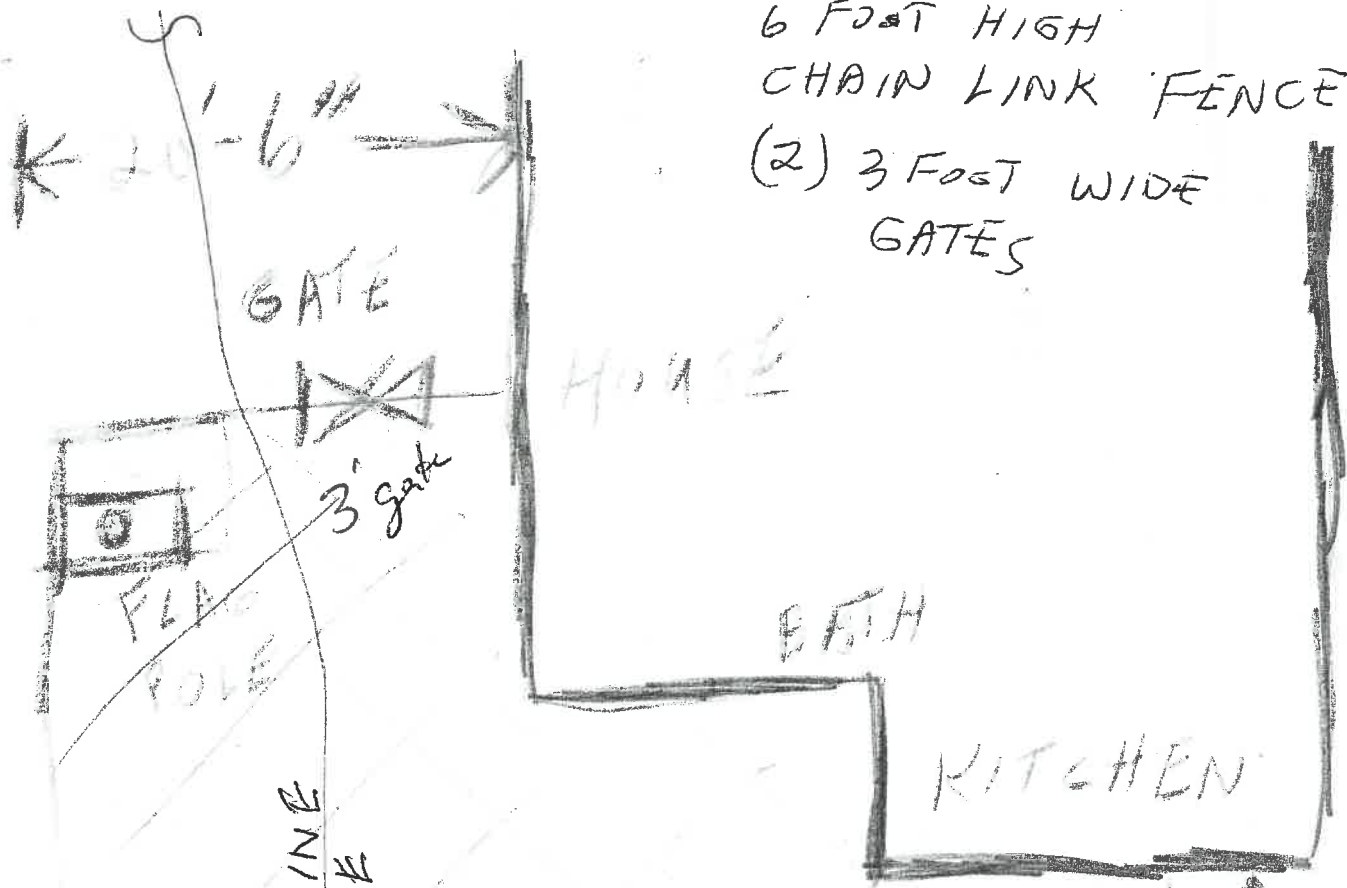

47 FEET

GAS LINE  
HERE

20-6  
47-0  
45-0  
47-0  
136-6

(2) 3'-0" WIDE GATES  
6 FEET HIGH FENCE

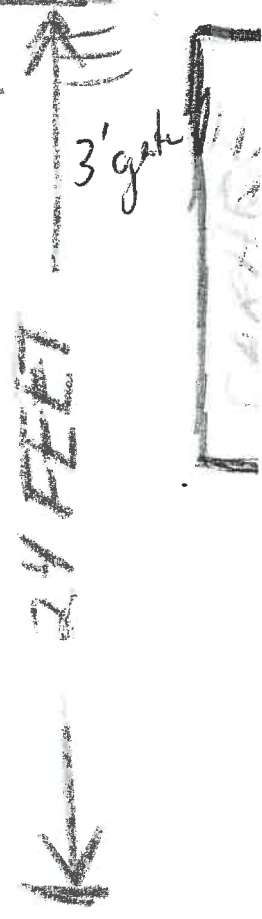

45 FEET

129 E. Barnes

CITY OF NAPOLEON INSPECTION FORM

PERMIT #: 1322

DATE ISSUED: 09-11-2002

JOB LOCATION: 129 E BARNES AVE

OWNER: PATRICK, DOYLE D.

OWNER PHONE: 419-592-6428

CONTRACTOR: B&W FENCE CO

CONTRACTOR PHONE: 419-822-3436

WORK DESCRIPTION: NEW FENCE

PLUMBING: UNDGR \_\_\_\_\_ RGHIN \_\_\_\_\_ FINAL \_\_\_\_\_

SEWER INSP \_\_\_\_\_

MECHANICAL: UNDGR \_\_\_\_\_ RGHIN \_\_\_\_\_ FINAL \_\_\_\_\_

FURNACE REPLC \_\_\_\_\_ AIR COND \_\_\_\_\_

ELECTRICAL: UNDGR \_\_\_\_\_ RGHIN \_\_\_\_\_ FINAL \_\_\_\_\_

SERV UPGR \_\_\_\_\_

BUILDING: SITE \_\_\_\_\_ FTG \_\_\_\_\_ FNDDT \_\_\_\_\_

STRUC \_\_\_\_\_ ROOF \_\_\_\_\_ EXT \_\_\_\_\_

VENT \_\_\_\_\_ ACCES \_\_\_\_\_ EGRS \_\_\_\_\_

SMKDT \_\_\_\_\_ FINAL \_\_\_\_\_

ISSUE TEMP OCCUP \_\_\_\_\_ ISSUE OCCUP \_\_\_\_\_

STRG SHED: SITE \_\_\_\_\_ FINAL \_\_\_\_\_

SIGN: FTG \_\_\_\_\_ FINAL \_\_\_\_\_

FENCE: SITE \_\_\_\_\_ FINAL \_\_\_\_\_

MISC INSP: \_\_\_\_\_

NOTES: \_\_\_\_\_

\_\_\_\_\_

\_\_\_\_\_

INSPECTOR INITIALS: \_\_\_\_\_